

57 Cowper Wharf Road Woolloomooloo NSW

1 

Located directly opposite the famous " Harry's Cafe de Wheels", this 65 sqm tenancy is available for lease.

Surrounded by residential properties, and some of Sydney's best restaurants and bars, this space is ideal for consultant offices, galleries, pharmacy, dentist, medical use, beauty clinic, and convenience store.

Note: Cafes or Restaurants are not acceptable.

Features of the space include:

- Brand new toilet and kitchenette facilities
- Freshly painted
- High levels of passing trade
- Good exposure
- Unbeatable location

Price : \$65,000 pa
Building Size : 65 sqm
Land Size : 65 sqm
View : <https://www.srmetro.com.au/lease/nsw/sydney-city/woolloomooloo/commercial/healthcare/8084494>



Farrah Cartwright
0420 311 618

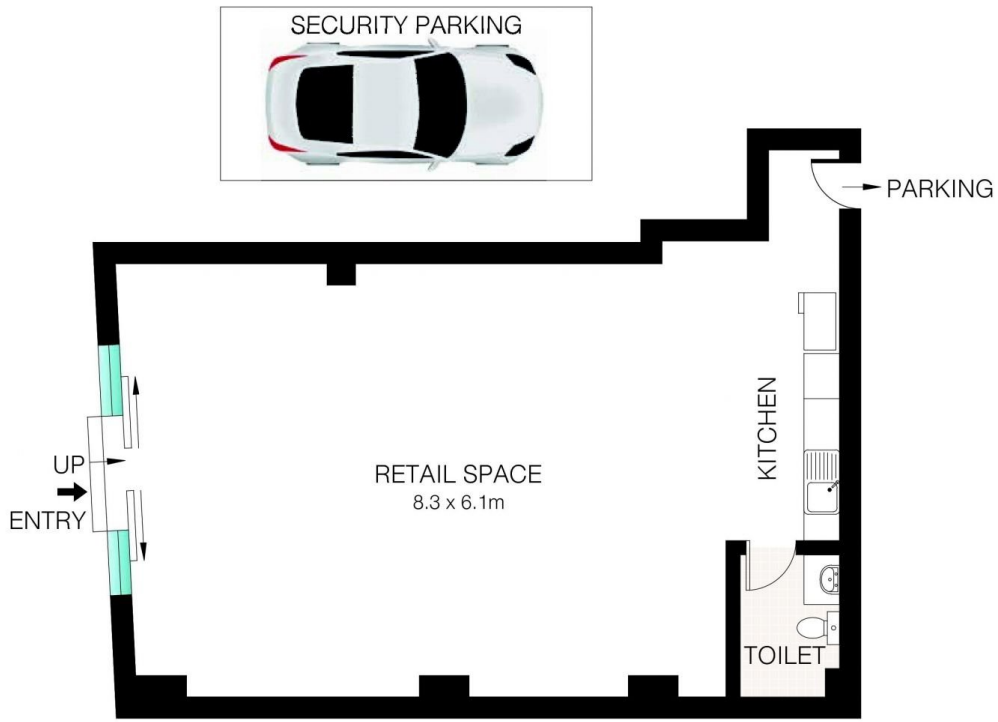

GROUND FLOOR



TOTAL: 65m²



This Floor Plan was prepared by WWW.CRYINGOUTLOUD.COM.AU for illustration purposes only. This document does not constitute any part of an offer or contract. Dimensions are approximate only. Copyright © 2024 Crying Out Loud. All Rights Reserved.

57 Cowper Wharf Road, Woolloomooloo