

Shop 4/11 Mashman Avenue Kingsgrove NSW

2 🚗

****DEPOSIT TAKEN**** Ideally situated in the heart of Kingsgrove and close to Kingsgrove Railway Station, this shop is suited for medical use, a dentist, a beauty clinic, or consultant offices, providing occupants with great exposure in the heart of the Kingsgrove CBD.

Features include:

- Air conditioning throughout
- After-hours access
- High-traffic area
- Modern bathroom and kitchenette facilities
- Internal area: approx. 100 sqm, plus 2 secure basement parking spaces
- Next to Pharmacy and Woolworths

[For full version visit the website](https://www.srmetro.com.au)

Type : Retail
Building Size : 106 sqm
View : <https://www.srmetro.com.au/lease/nsw/s-t-george/kingsgrove/commercial/retail/8023228>



Farrah Cartwright
0420 311 618

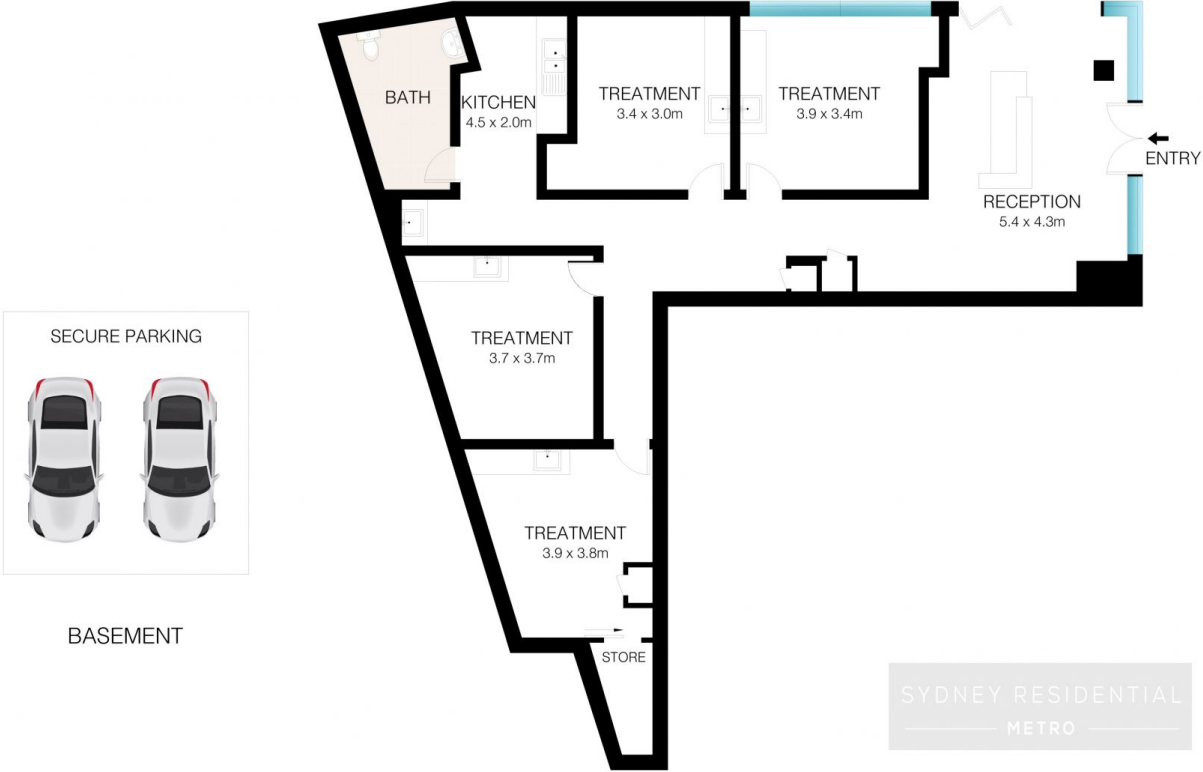

0 1 2 3 4 5

GROUND FLOOR

INT: 106m²



This Floor Plan was prepared by WWW.CRYINGOUTLOUD.COM.AU for illustration purposes only. This document does not constitute any part of an offer or contract. Dimensions are approximate only. Copyright © 2024 Crying Out Loud. All Rights Reserved.

4/11 Mashman Avenue, Kingsgrove