



### Level 26/2 Quay Street Sydney NSW

3 2 1

With a coveted N/E position in a landmark development "The Peak", this sunny haven is dazzled by panoramic views of the city, - truly breathtaking scenery by day or night.

**Type** : Apartment

**View** : <https://www.srmetro.com.au/lease/nsw/sydney-city/sydney/residential/apartment/5716322>

This superbly presented 3 bedroom apartment features:

- Vast living & dining leads to suntrap balcony flooded with natural light
- Large picture windows framing the stunning view
- Granite kitchen with gas appliances & parquet flooring
- All bedrooms with built-in robes and master with ensuite
- R/C air-conditioning; excellent condition throughout
- Security carspace
- 24 hr concierge service; full amenities which include



**Cathryn Chen**  
02 9283 2832

[For full version visit the website](https://www.srmetro.com.au)

<https://www.srmetro.com.au>

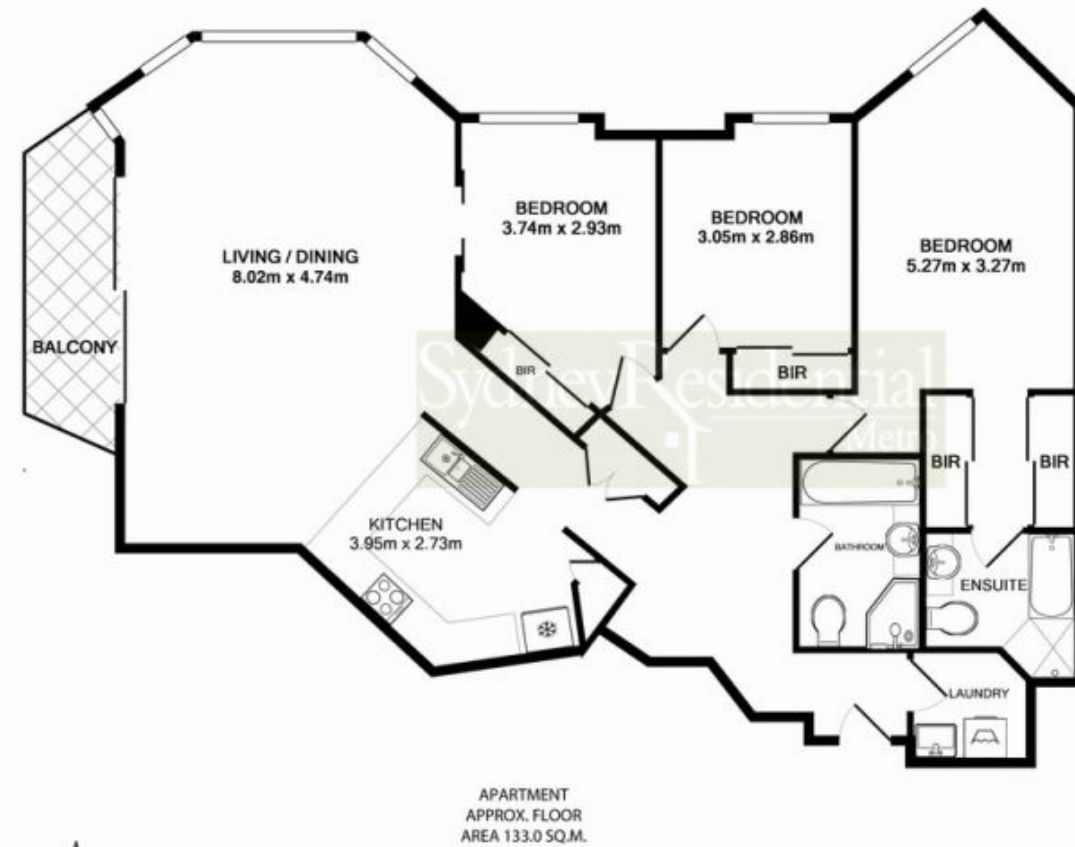

SECURE CAR SPACE  
APPROX. FLOOR  
AREA 15.0 SQ.M

TOTAL APPROX. FLOOR AREA 148.0 SQ.M.  
Measurements are approximate. Not to Scale. For illustrative purposes only.  
Produced by Open2View.com.au